

NEW

ALTER SERIES

This aluminum retrofit LED panel offers the easiest and most practical solution for upgrading your outdated recessed lighting. For style and convenience, the removable outer trim attaches with magnetic fasteners, creating a seamless look. It can be easily retrofitted into existing 4" canisters or standard octagonal junction boxes.

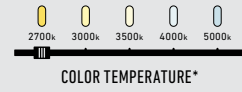

**T24
JA8**
CERTIFIED



Model	Size	Watts	Delivered lumens	CRI	Color °T	Voltage
RTJB4-3K	4"	9 W	550 lm	90	3000 K	120 V
RTJB3-CC	3"	8 W	620 lm		2700, 3000, 3500, 4000, 5000 K	
RTJB4-CC	4"	9 W	565 lm			

*Not available for model RTJB4-3K

RTJB3-CC

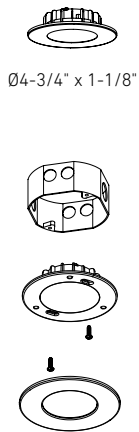

RTJB4-XX + RTJB4-ACC

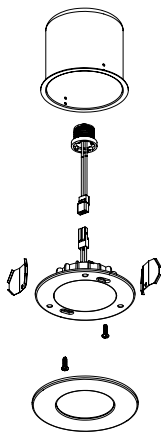

RTJB4-XX

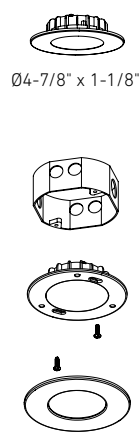

Specifications

- Fits on U.S. and Canadian octagonal junction boxes (RTJB3 only)
- Integrated dimmable driver
- Fire rated alternative when mounted onto a fire rated junction box
- Minimal heat emission
- Aluminum construction
- Switch-selectable CCT (models RTJB3-CC, RTJB4-CC only)
- Magnetic trim finish
- 5-year warranty

Finish

- WH** White

Accessories

- RTJB4-ACC**
4" recessed can mounting kit for RTJB4-XX - clips and E26 socket
- RTJB4-TRIM-BK**
4" recessed panel trim in black

Note

Other color temperatures, finishes, and voltage options are available but may require minimum order quantities (MOQs) and longer lead times. Please contact your DALI representative for more information.